

2013 CIVL 498C

Level 3 Elemental Construction Format

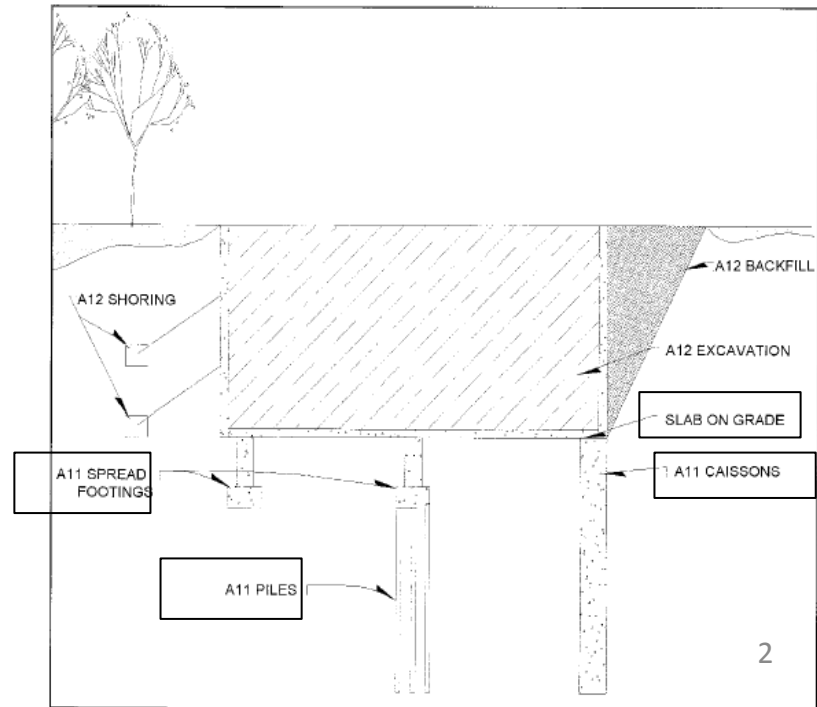
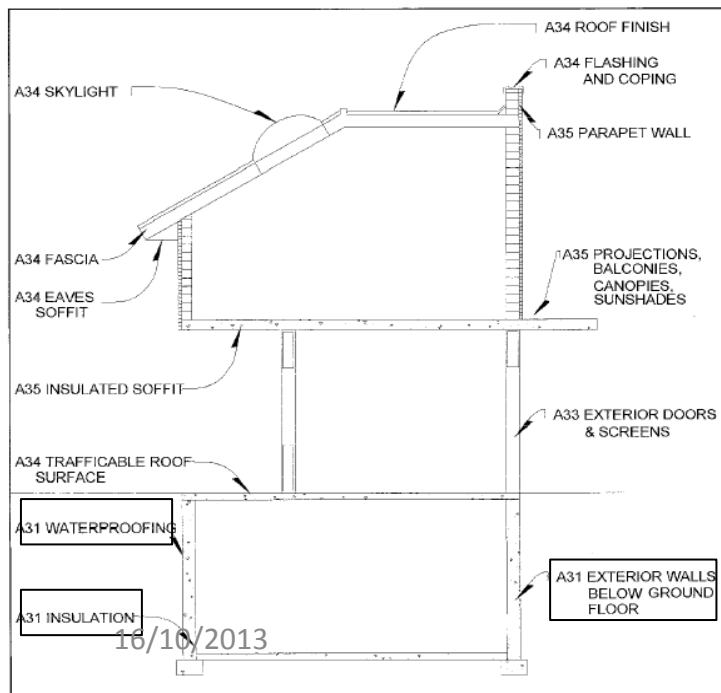
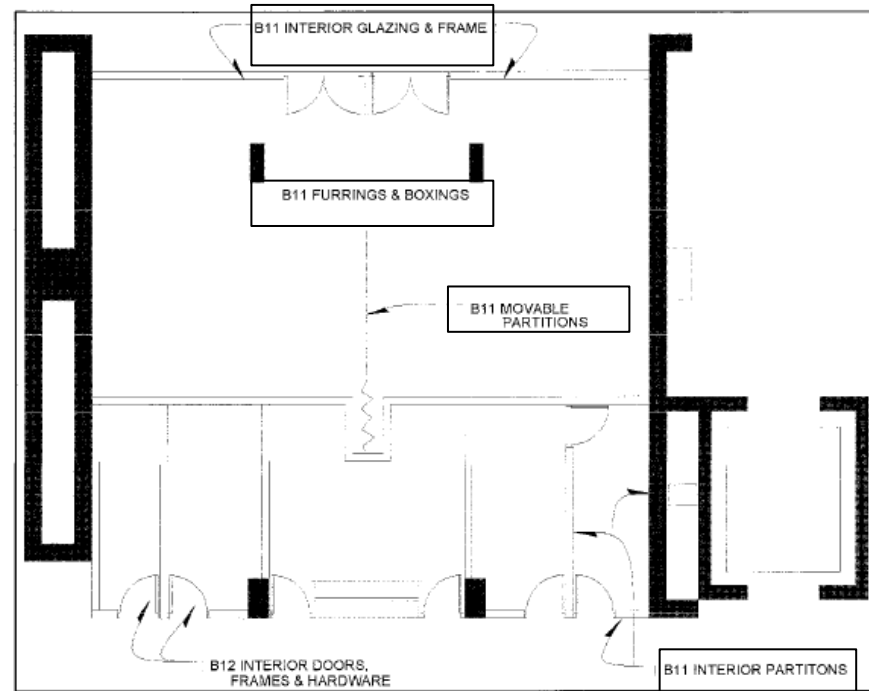
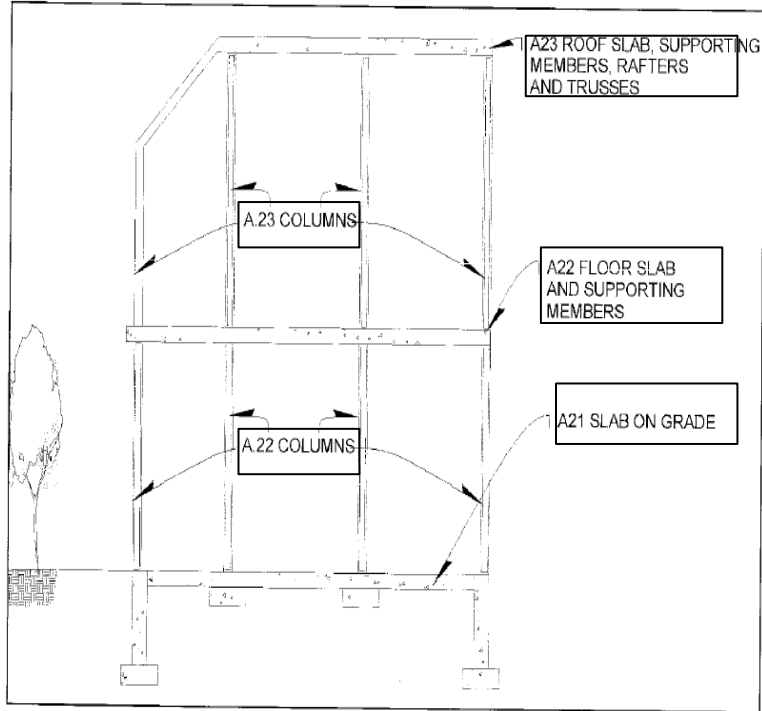

16/10/2013

Level 3 Elements included in CIVL 498C Final Project	Other CIQS Level 3 Elements to be included for CIVL 498C Final Projects	Units	Description of what to measure
A11 Foundations	A12 Shoring	m ²	Total area of the slab-on-grade.
Lowest Floor A21 Construction		m ²	Total area of the slab-on-grade.
Upper Floor A22 Construction		m ²	Sum of the total area of all upper floor(s) measured from the outside face of the exterior walls.
A23 Roof Construction	A34 Eaves Soffit A34 Fascia A34 Skylight, A34 Roof Finish, A34 Flashing and Coping, A34 Trafficable roof surface,	m ²	Sum of total area of the roof(s) measured from the outside face of the exterior walls.
A31 Walls Below Grade		m ²	Sum of total surface area of the exterior walls below grade.
A32 Walls Above Grade	A33 Exterior Doors & Screens A35 Parapet wall A35 Projections, Balconies, Canopies, Sunshades A35 Insulated Soffit	m ²	Sum of total surface area of the exterior walls above grade.
B11 Partitions	B12 Interior Doors Frames & Hardware	m ²	Sum of total surface area of the interior walls.

NOTE - Delete the finishes named below when you see them. They are not specified in the Object of Assessment for your Final Project studies.

